

RB520S-30AT

Surface Mount Schottky Barrier Rectifier

Reverse Voltage: 30 V Forward Current: 1.0A

Feature

- ◆ Low Forward Voltage Drop
- ◆ Flat Lead SOD-523 Small Outline Plastic Package
- ◆ Matte Tin(Sn) Lead Finish

PINNING

PIN	DESCRIPTION
1	Cathode
2	Anode

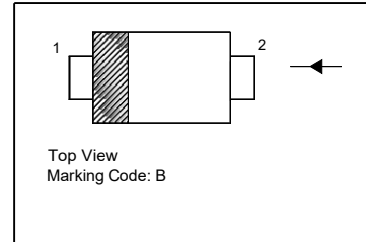

Absolute Maximum Ratings and Characteristics

Ratings at 25°C ambient temperature unless otherwise specified, single phase, half wave, resistive or inductive load.

For capacitive load, derate by 20%

Parameter	Symbols	RB520S-30AT	Units
Maximum Repetitive Peak Reverse Voltage	V_{RRM}	30	V
Maximum Average Forward Rectified Current	$I_{F(AV)}$	200	mA
Peak Forward Surge Current 8.3 ms Single Half Sine Wave Superimposed on Rated Load(JEDEC methode)	I_{FSM}	1	A
Breakdown Voltage	V_{BR}	30	V
Forward voltage	V_F	0.6	V
Reverse Current	I_R	1	uA
Power Dissipation	P_D	200	mW
Junction Temperature	T_j	125	°C
Storage Temperature Range	T_{stg}	- 55 to + 150	°C

RB520S-30AT

Typical Characteristics Curves

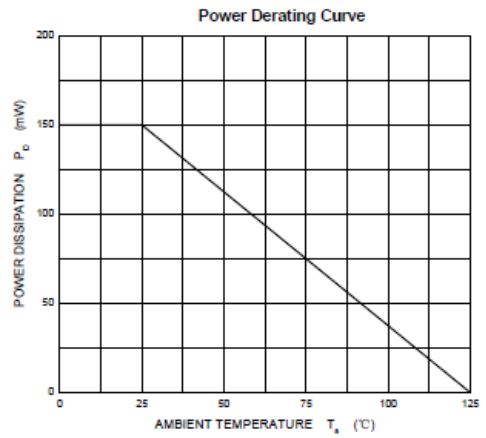
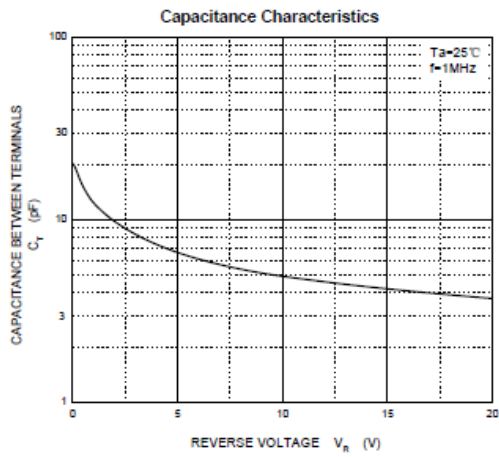
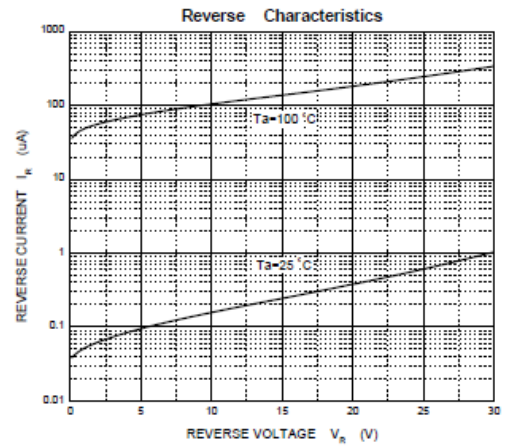
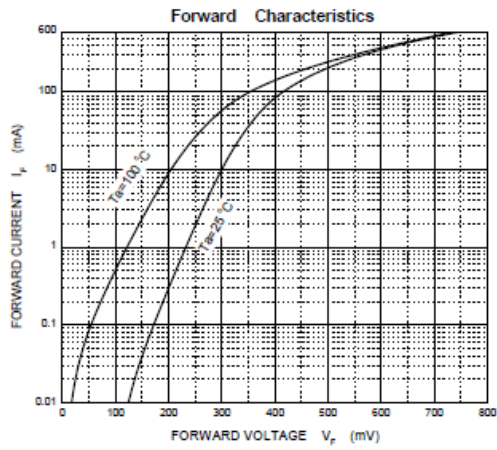

RB520S-30AT

Package Outline

SOD-523

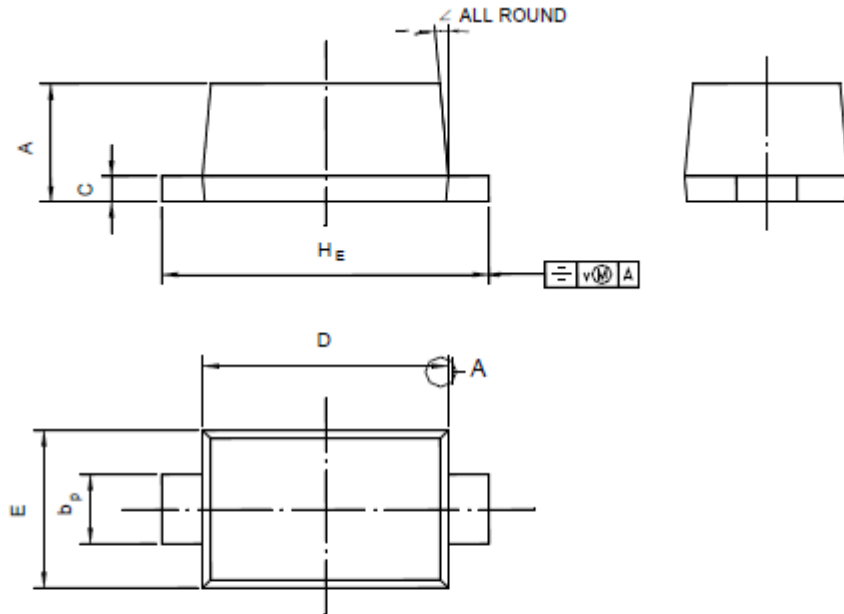

UNIT	A	b _p	C	D	E	H _E	V	∠
mm	0.70 0.60	0.4 0.3	0.135 0.100	1.25 1.15	0.85 0.75	1.7 1.5	0.1	5°